

## B50-2



## B50-2

### Suction cup with short bellows and filter disk

- Suitable for level adjustment. Several short bellows in one lifting device can handle objects with height differences and varying shapes, for example embossed or corrugated plates.
- Lifting movement to separate small and thin objects.
- Only lightweight objects should be handled when the lifting force is parallel to the surface of the object, in order to achieve good precision and safe lifting movement.
- Filter disk made of PE.

#### Lifting forces & Technical data

Outer Dia.	Lifting force vertical to the surface, lbf, at vacuum level			Lifting force parallel to the surface, lbf, at vacuum level			Volume	Min. curve radius	Max. vertical movement	Weight rubber part
	6 -inHg	18 -inHg	27 -inHg	6 -inHg	18 -inHg	27 -inHg				
in							in <sup>3</sup>	in	in	oz
2.09	7.42	14.6	18.4	—	—	—	1.95	1.18	0.75	0.71

#### Material specifications

Material	Color	Hardness °Shore A	Temperature range °F
Nitrile-PVC, NPV	Black	50	32–194*
Silicone, SIL	Red	50	-40–392*

\*Filter disk max. 176°F

#### Material resistance

Material	Wear resistance	Oil	Weather & Ozone	Hydrolysis	Gasoline	Concentrated acids	Alcohol	Oxidation
Nitrile-PVC, NPV	Excellent	Excellent	Good	Good	Excellent	Fair	Good	Good
Silicone, SIL	Good	Poor	Excellent	Fair	Poor	Poor	Good	Excellent

## Ordering information

	Suction cups with fitting	Weight (oz)	Part No.
A	Suction cup B50-2 Nitrile-PVC, 1/8" NPSF female	1.06	B50-2.30.05AA
A	Suction cup B50-2 Nitrile-PVC with filter, 1/8" NPSF female, with mesh filter	1.06	B50-2.30.05AG
A	Suction cup B50-2 Nitrile-PVC with filter, 1/8" NPSF female, with dual flow control valve	1.06	B50-2.30.05DA
B	Suction cup B50-2 Nitrile-PVC with filter, G1/4" male, with mesh filter	1.06	B50-2.30.05AB
B	Suction cup B50-2 Nitrile-PVC with filter, G1/4" male, with dual flow control valve and mesh filter	1.06	B50-2.30.05DB
B	Suction cup B50-2 Nitrile-PVC, 1/4" NPT male, with mesh filter	1.06	B50-2.30.05AC
C	Suction cup B50-2 Nitrile-PVC with filter, G3/8" male, with mesh filter	1.06	B50-2.30.05AD
C	Suction cup B50-2 Nitrile-PVC, 3/8" NPT male, with mesh filter	1.06	B50-2.30.05AE
D	Suction cup B50-2 Nitrile-PVC with filter, 5x1/8" NPSF female	1.77	B50-2.30.05AF
A	Suction cup B50-2 Silicone, 1/8" NPSF female	1.06	B50-2.20.05AA
A	Suction cup B50-2 Silicone with filter, 1/8" NPSF female, with mesh filter	1.06	B50-2.20.05AG
A	Suction cup B50-2 Silicone with filter, 1/8" NPSF female, with dual flow control valve	1.06	B50-2.20.05DA
B	Suction cup B50-2 Silicone with filter, G1/4" male, with mesh filter	1.06	B50-2.20.05AB
B	Suction cup B50-2 Silicone, 1/4" NPT male, with mesh filter	1.06	B50-2.20.05AC
C	Suction cup B50-2 Silicone with filter, G3/8" male, with mesh filter	1.06	B50-2.20.05AD
C	Suction cup B50-2 Silicone, 3/8" NPT male, with mesh filter	1.06	B50-2.20.05AE
D	Suction cup B50-2 Silicone with filter, 5x1/8" NPSF female	1.77	B50-2.20.05AF
E	Suction cup B50-2 Nitrile-PVC with filter, 1/8" NPSF female, PA	0.91	B50-2.30.05CA
E	Suction cup B50-2 Silicone with filter, 1/8" NPSF female, PA	0.91	B50-2.20.05CA

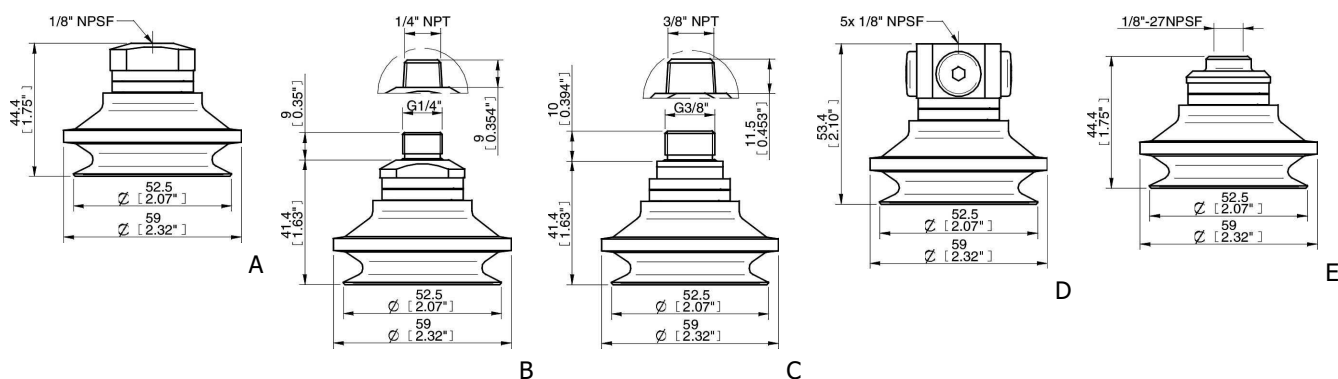

Rubber parts	Part No.
Suction cup B50-2 Nitrile-PVC, with filter disk	B50-2.30
Suction cup B50-2 Silicone, with filter disk	B50-2.20

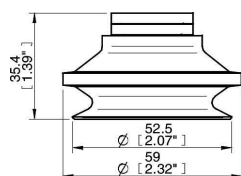

Fittings	Part No.
Fitting 1/8" NPSF female, 50	05AA
Fitting 1/8" NPSF female, 50, with mesh filter	05AG
Fitting 1/8" NPSF female, 50, with dual flow control valve	05DA

Fitting G1/8" male, 50, with mesh filter	05AI
Fitting G1/4" male, 50, with mesh filter	05AB
Fitting G1/4" male, with dual flow control valve	05DB
Fitting 1/4" NPT male, with mesh filter	05AC
Fitting 1/4" NPT male, with dual flow control valve	05DC
Fitting G3/8" male, 50, with mesh filter	05AD
Fitting G3/8" male, 50, with mesh filter and dual flow control valve	05DD
Fitting 3/8" NPT male, with mesh filter	05AE
Fitting 3/8" NPT male, with dual flow control valve	05DE
Fitting 5x1/8" NPSF female, 50	05AF
Fitting 5x1/8" NPSF female, 50, with dual flow control valve	05DF
Fitting 1/8" NPSF female, 50, PA	05CA

Spare Part	Material	Temperature range °F	Part No.
Filter D=54, 20 pcs, for B50-2	Polyethylene, PE	-40–176	01.04.655