

Vacuum Check Valve VT1



Vacuum Check Valve VT1

- Check valve that traps vacuum in sealed applications for safe operation.
- Built-in blow off check valve for fast release of object.
- Optional two-stage COAX® cartridge MINI Pi12-2 integrated.
- Optional integrated energy-saving device, Vacustat results in virtually no air consumption in sealed applications.
- Recommend using 4mm (5/32") tubing and no more than 80 psi for blow off.
- Recommend using 6mm (1/4") tubing and no more than 80 psi for vacuum.
- Equal line lengths from common manifold should be used for both blow-off and vacuum.
- Maximum of (12) units per tool.

Technical data

Description	Unit	Value
Feed pressure, max.	MPa	0.55
Feed pressure, min. breakaway blow-off	MPa	0.25
Material		Al, Steel, Ceramic

Technical data, specific

Description	Unit	Value		
		0109233/0121236	0110456/0121237	0120323/0121238
Weight	g	272	390	650
Temperature range	°C	-30-70	-10-80	-10-80
Noise level	dBa	—	66-68	66-68
Signal	-kPa	—	—	65
Function		—	—	2/2 NO
Hysteresis	kPa	—	—	8
Vacuum flow, max.	NI/s	—	0.68	0.68

Vacuum flow

Feed pressure*	Air consumption	Vacuum flow (NI/s) at different vacuum levels (-kPa)										Max vacuum
		0	10	20	30	40	50	60	70	80	-kPa	
0.17	0.29	0.57	0.40	0.22	0.15	0.070	—	—	—	—	49	
0.22	0.34	0.64	0.48	0.29	0.20	0.14	0.080	0.020	—	—	64	
0.314	0.44	0.68	0.60	0.44	0.27	0.19	0.14	0.10	0.060	0.030	90	
0.40	0.53	0.66	0.60	0.52	0.39	0.24	0.12	0.10	0.060	0.020	84	

*Feed pressure tolerance, +/- 0.01 MPa

Evacuation time

Feed pressure* MPa	Air consumption NI/s	Evacuation time (s/l) to reach different vacuum levels (-kPa)								Max vacuum -kPa
		10	20	30	40	50	60	70	80	
0.17	0.29	0.28	0.56	1.13	2.13	—	—	—	—	49
0.22	0.34	0.20	0.42	0.85	1.5	2.3	3.0	—	—	64
0.314	0.44	0.17	0.32	0.58	1.1	1.8	2.7	4.0	6.4	90
0.40	0.53	0.18	0.33	0.54	0.85	1.5	2.5	3.8	7.1	84

*Feed pressure tolerance, +/- 0.01 MPa

Ordering information

Description	Art. No.
A Vacuum Check Valve VT1 G3/8"-G1/4"	X1000 / 0109233
A Vacuum Check Valve VT1 3/8"NPT-1/4"NPT	1000 / 0121236
B Vacuum Check Valve VT1 COAX® cartridge MINI Pi12-2, non-return valve G3/8"-G1/4"	X1041 / 0110456
B Vacuum Check Valve VT1 COAX® cartridge MINI Pi12-2, 3/8"NPT-1/4"NPT	1041 / 0121237
C Vacuum Check Valve VT1 Vacustat COAX® cartridge MINI Pi12-2, G3/8"-G1/4"	X2098 / 0120323

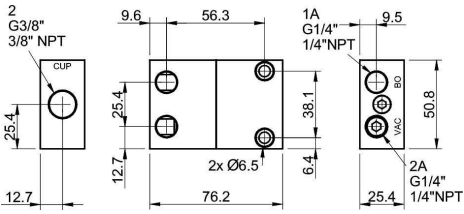

A

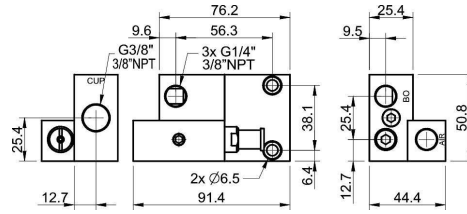

B

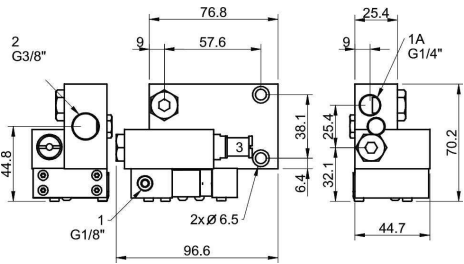

C