

BX15P



BX15P

- Suitable for level adjustment and for uneven and porous surfaces such as cardboard, etc.
- In the two-colored suction cup the bellows and the sealing lip are of different hardnesses, which makes the suction cup strong and stable and, at the same time, soft and flexible.
- DURAFLEX® suction cups manufactured in a specially developed material that features the elasticity of rubber and wear resistance of polyurethane.
- The material DURAFLEX® is mark free.

Lifting forces & Technical data

Material	Lifting force vertical to the surface, lbf, at vacuum level			Lifting force parallel to the surface, lbf, at vacuum level			Volume in ³	Min. curve radius in	Max. vertical movement in	Weight rubber part oz
	6 -inHg	18 -inHg	27 -inHg	6 -inHg	18 -inHg	27 -inHg				
PU30°/60°	0.45	0.90	1.01	—	—	—	0.06	0.22	0.22	0.041
PU60°	0.45	1.35	1.35	—	—	—	0.06	0.24	0.22	0.040

Material specifications

Material	Color	Hardness °Shore A	Temperature range °F
Polyurethane, PU30	Yellow transparent	30	50–122
Polyurethane, PU60	Green transparent	60	50–122

Material resistance

Wear resistance	Oil	Weather & ozone	Hydrolysis	Gasoline	Concentrated acids	Ethanol	Methanol	Oxidation
Excellent	Excellent	Excellent	Fair	Fair	Fair	Fair	Poor	Poor

Ordering information

Suction cups with fitting	Weight (oz)	Part No.
Suction Cup BX15P Polyurethane 30/60, M5 male	0.181	BX15P.4K.01AC
Suction Cup BX15P Polyurethane 60, M5 male	0.180	BX15P.4E.01AC

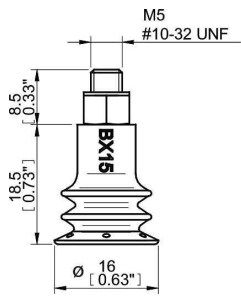

Description	Part No.
Suction cup BX15P Polyurethane 30/60	BX15P.4K
Suction cup BX15P Polyurethane 60	BX15P.4E

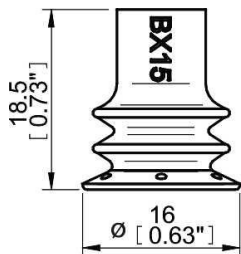

Fittings	Part No.
Fitting M5 male, 10–15	01AC